

EL ALFS series

ALFS1G-C010001H-AM



Features

- Package : SMD ceramic package
- Typ. Color Temperature : 5850K
- Typ. Luminous Flux : 380 lm @1000mA
- Viewing angle : 120°
- ESD : up to 8KV
- MSL : 2
- Qualifications : According to AEC-Q102
- The product itself will remain within RoHS compliant version.
- Compliance with EU REACH.
- Compliance Halogen Free .(Br <900 ppm ,Cl <900 ppm , Br+Cl < 1500 ppm).
- Sulfur robustness

Applications

- Automotive Exterior Lighting
- Headlamp
- Daytime running light (DRL)
- Fog lamp

Contents

1. Characteristics.....	3
2. Absolute Maximum Ratings.....	4
3. Characteristics Graph.....	5
4. Binning Information.....	10
5. Part Number.....	14
6. Ordering Information.....	15
7. Mechanical Dimension.....	16
8. Recommended Soldering Pad.....	17
9. Reflow Soldering Profile.....	18
10. Packaging Information.....	19
11. Precaution for Use.....	21

EVERLIGHT

1. Characteristics

Parameter	Symbol	Min.	Typ.	Max.	Unit	Condition
Forward current ^[1]	I_F	50	1000	1500	mA	
Luminous Flux ^{[2][3]}	Φ_v	360	380	450	lm	$I_F=1000\text{mA}$
Forward Voltage ^{[4][5]}	V_F	2.90	3.30	3.80	V	$I_F=1000\text{mA}$
Viewing Angle	ϕ	---	120	---	deg	$I_F=1000\text{mA}$
Color	K	5180	---	6680	K	$I_F=1000\text{mA}$
Thermal Resistance (Junction to Solder)	$R_{th\ JS\ real}$	---	4.0	4.4	K/W	$I_F=1000\text{mA}$
	$R_{th\ JS\ el}$	---	3.0	3.4		

Notes:

1. Luminous flux measurement tolerance: $\pm 8\%$
2. The data of luminous flux measured at thermal pad=25°C
3. Forward voltage measurement tolerance: $\pm 0.05\text{V}$
4. Current pulse time: 25ms

2. Absolute Maximum Ratings

Parameter	Symbol	Ratings	Unit
Reverse Voltage	V_R	Not designed for reverse operation	V
Power Dissipation	P_d	5700	mW
Forward Current	I_F	1500	mA
Junction Temperature	T_J	150	°C
Operating Temperature	T_{opr}	-40 ~ +125	°C
Storage Temperature	T_{stg}	-40 ~ +125	°C
ESD Sensitivity (R=1.5kΩ, C= 100pF)	ESD_{HBM}	8	KV
Soldering Temperature	Reflow	260	°C

EVERLIGHT

3. Characteristics Graph

Wavelength Characteristics Relative Spectral Distribution
@ $T_s = 25^\circ\text{C}$ 、 $I_F = 1000\text{mA}$

$$\Phi_V / \Phi_V (\text{Max.}) = f(\lambda)$$

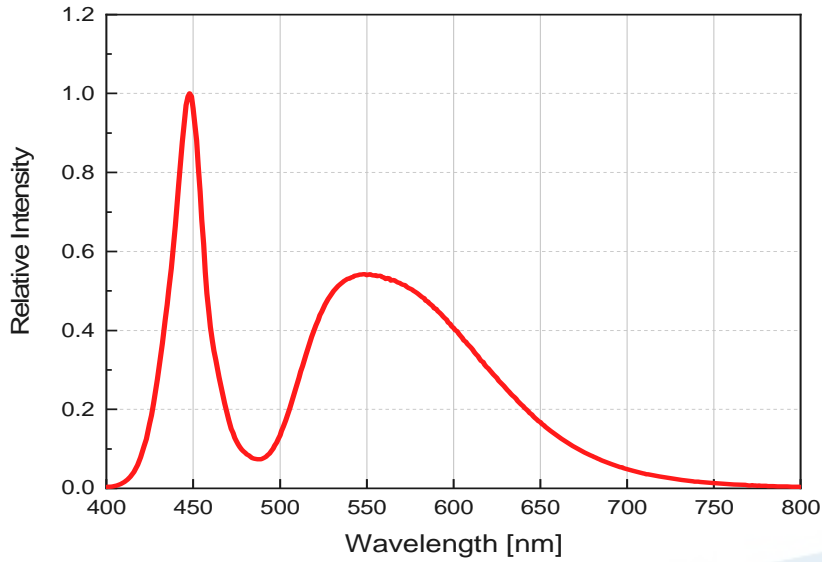

Typical Diagram Characteristics of Radiation

$$\Phi_V / \Phi_V (0^\circ) = f(\varphi)$$

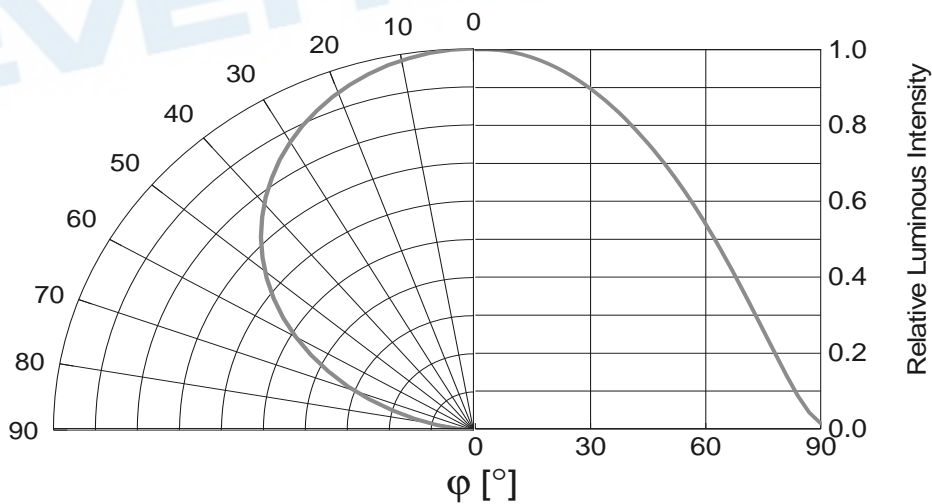

Notes:

1. φ is the off axis angle from lamp centerline where the luminous intensity is 1/2 of the peak value.
2. View angle tolerance is $\pm 5^\circ$

Forward Current vs. Forward Voltage
@ T_s = 25°C

$$I_F = f(V_F)$$

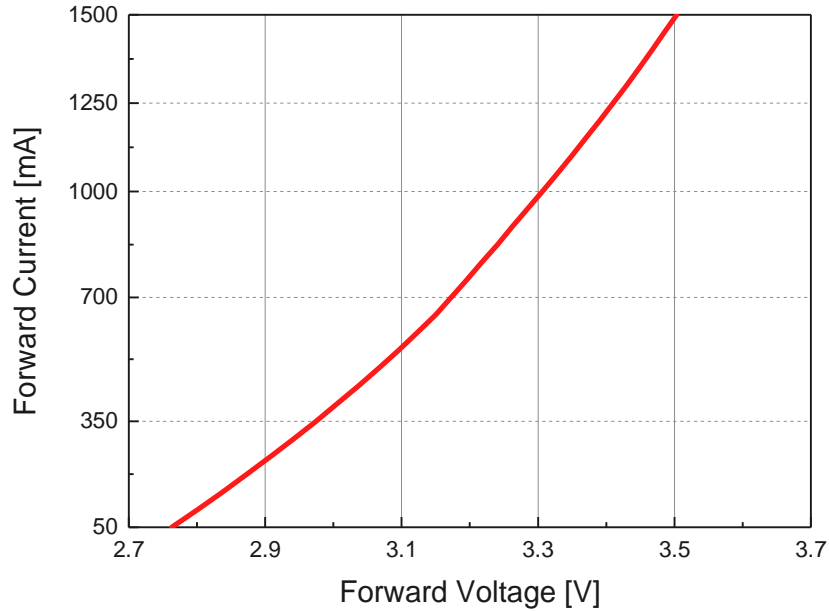

Relative Luminous Flux vs. Forward Current
@ T_s = 25°C

$$\Phi_V / \Phi_V(1000mA) = f(I_F)$$

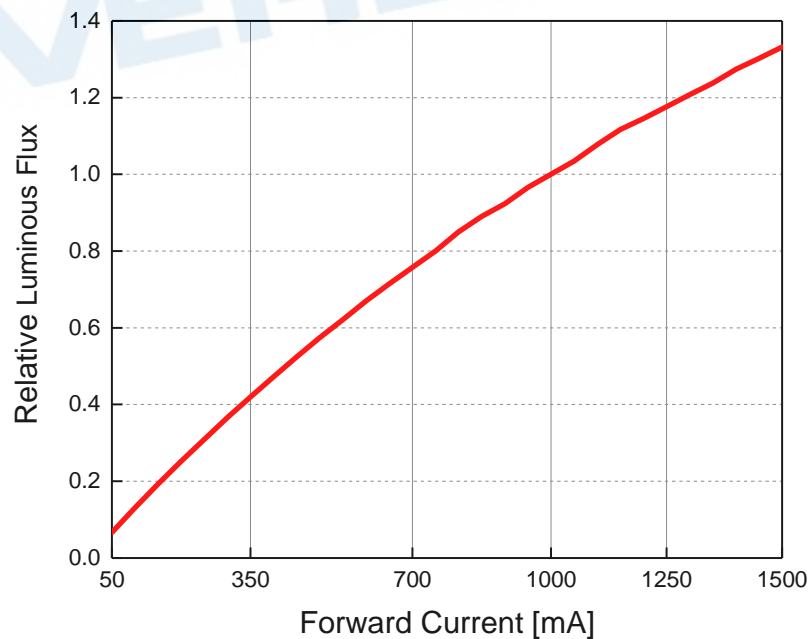

Chromaticity Coordinates vs. Forward Current @ $T_s = 25^\circ\text{C}$

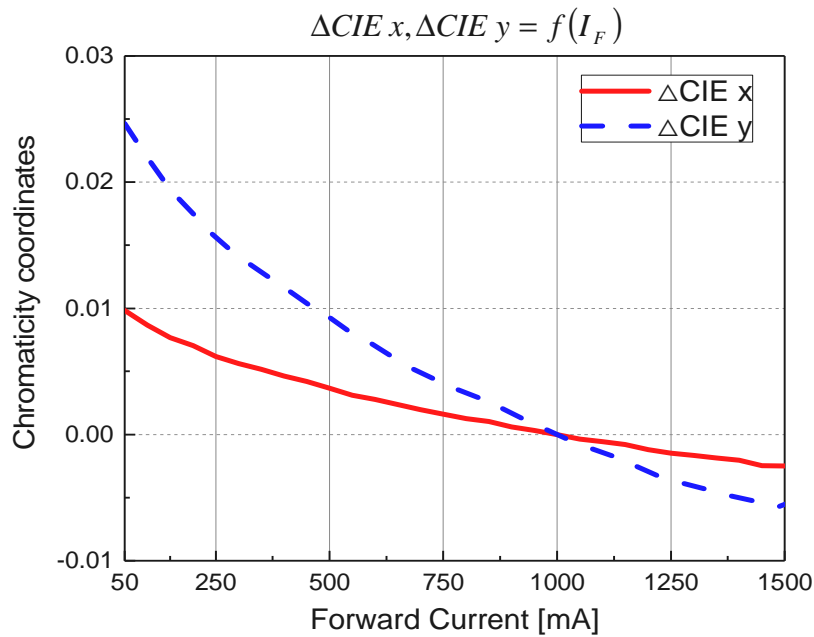

Relative Forward Voltage vs. Junction Temperature @ $I_F = 1000\text{mA}$

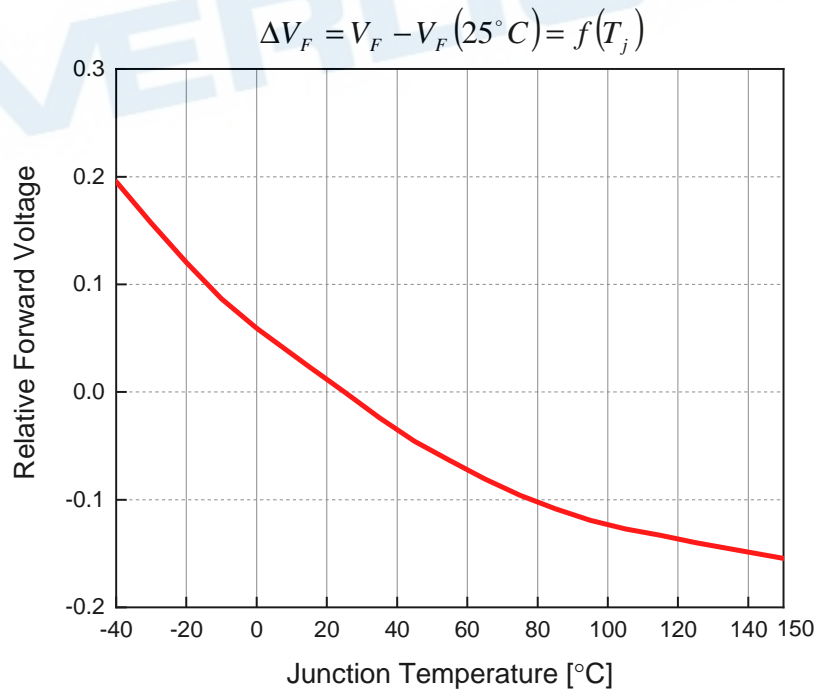

Relative Luminous Flux vs. Junction Temperature
@ I_F = 1000mA

$$\Phi_v / \Phi_v(25^\circ C) = f(T_j)$$

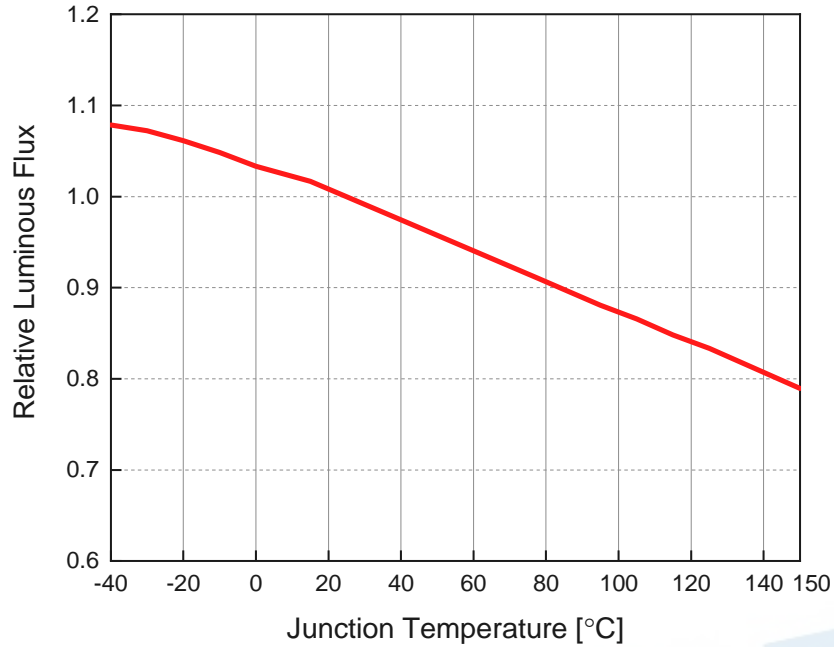

Chromaticity Coordinates Shift vs. Junction Temperature
@ I_F = 1000mA

$$\Delta CIE_x, \Delta CIE_y = f(T_j)$$

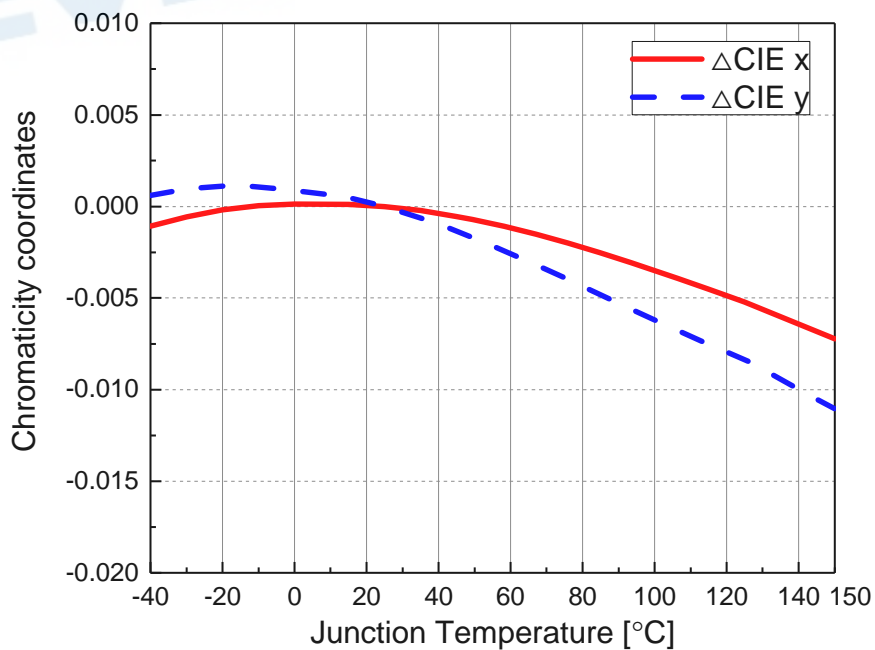

Forward Current Derating Curve

$$I_F = f(T_S)$$

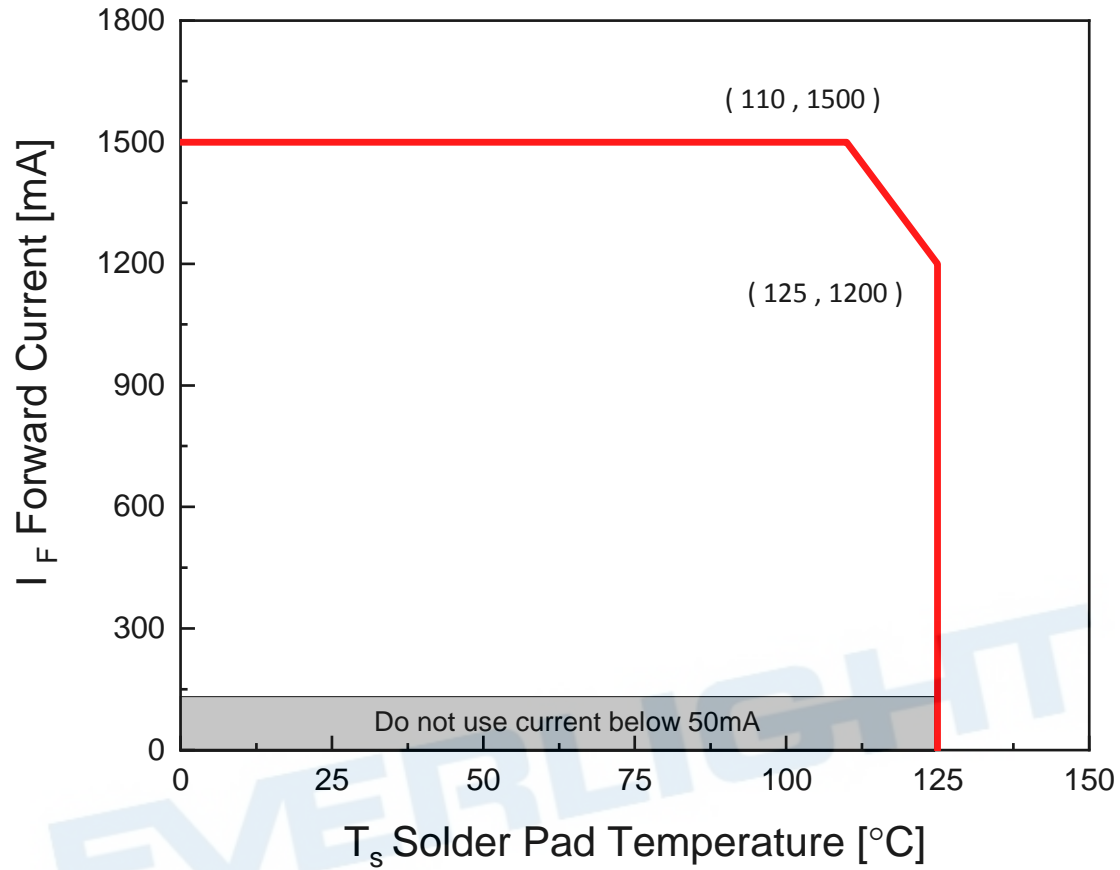

4. Binning Information

Luminous Intensity Bins

[Cool White]			
Group	Bin	Minimum Photometric Flux (lm)	Maximum Photometric Flux (lm)
C	4	360	380
	5	380	400
D	1	400	450

Notes:

1. Luminous flux measurement tolerance: $\pm 8\%$
2. Test current: Typical forward current
3. Current pulse time: 25ms

EVERLIGHT

Forward Voltage Bins

Group	Minimum Forward Voltage(V)	Maximum Forward Voltage(V)
1A	2.90	3.20
1B	3.20	3.50
1C	3.50	3.80

Notes:

1. Forward Voltage measurement tolerance: $\pm 0.05V$
2. Test current: Typical forward current
3. Current pulse time: 25ms

EVERLIGHT

Color Bin Structure ECE Bin Structure

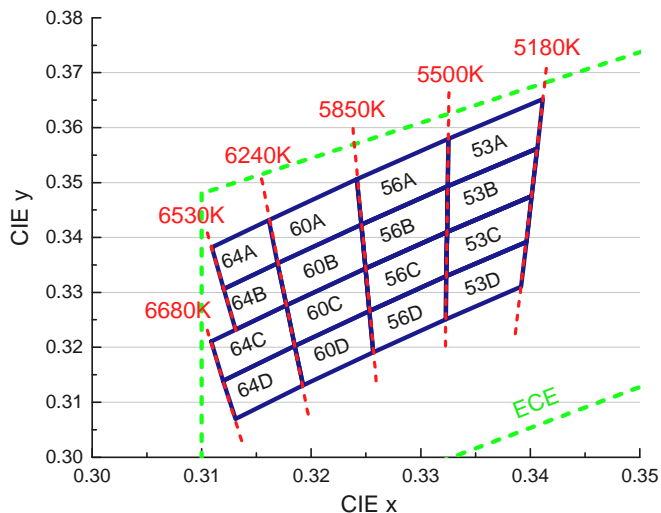
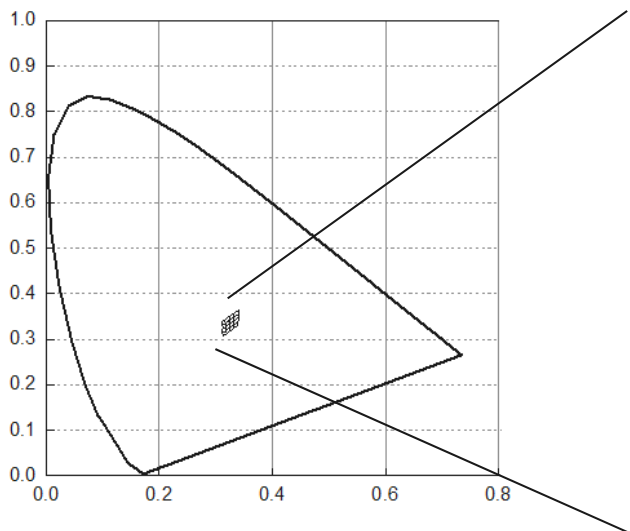

Cool White Bin Coordinates

Bin	CIE x	CIE y
64A	0.3109	0.3382
	0.3161	0.3432
	0.3169	0.3353
	0.3120	0.3306
Reference Range: 6240~6530K		

Bin	CIE x	CIE y
64B	0.3120	0.3306
	0.3169	0.3353
	0.3177	0.3277
	0.3131	0.3232
Reference Range: 6240~6530K		

Bin	CIE x	CIE y
64C	0.3109	0.3211
	0.3177	0.3277
	0.3185	0.3203
	0.3120	0.3139
Reference Range: 6240~6680K		

Bin	CIE x	CIE y
64D	0.3120	0.3139
	0.3185	0.3203
	0.3192	0.3131
	0.3131	0.3070
Reference Range: 6240~6680K		

Bin	CIE x	CIE y
60A	0.3161	0.3432
	0.3242	0.3506
	0.3246	0.3424
	0.3169	0.3353
Reference Range: 5850~6240K		

Bin	CIE x	CIE y
60B	0.3169	0.3353
	0.3246	0.3424
	0.3249	0.3344
	0.3177	0.3277
Reference Range: 5850~6240K		

Bin	CIE x	CIE y
60C	0.3177	0.3277
	0.3249	0.3344
	0.3253	0.3266
	0.3185	0.3203
Reference Range: 5850~6240K		

Bin	CIE x	CIE y
60D	0.3185	0.3203
	0.3253	0.3266
	0.3256	0.3191
	0.3192	0.3131
Reference Range: 5850~6240K		

Bin	CIE x	CIE y
56A	0.3242	0.3506
	0.3325	0.3579
	0.3325	0.3493
	0.3246	0.3424
Reference Range: 5500~5850K		

Bin	CIE x	CIE y
56B	0.3246	0.3424
	0.3325	0.3493
	0.3324	0.3410
	0.3249	0.3344
Reference Range: 5500~5850K		

Bin	CIE x	CIE y
56C	0.3249	0.3344
	0.3324	0.3410
	0.3323	0.3329
	0.3253	0.3266
Reference Range: 5500~5850K		

Bin	CIE x	CIE y
56D	0.3253	0.3266
	0.3323	0.3329
	0.3323	0.3251
	0.3256	0.3191
Reference Range: 5500~5850K		

Bin	CIE x	CIE y
53A	0.3325	0.3579
	0.3412	0.3652
	0.3406	0.3562
	0.3325	0.3493
Reference Range: 5180~5500K		

Bin	CIE x	CIE y
53B	0.3325	0.3493
	0.3406	0.3562
	0.3401	0.3476
	0.3324	0.3410
Reference Range: 5180~5500K		

Bin	CIE x	CIE y
53C	0.3324	0.3410
	0.3401	0.3476
	0.3396	0.3392
	0.3323	0.3329
Reference Range: 5180~5500K		

Bin	CIE x	CIE y
53D	0.3323	0.3329
	0.3396	0.3392
	0.3392	0.3310
	0.3323	0.3251
Reference Range: 5180~5500K		

Notes:

1. Color coordinates measurement tolerance: ± 0.005
2. Test current: Typical forward current
3. Current pulse time: 25ms

5. Part Number

ALFS1G-C010001H-AM

Part number is designated with below details.

ALFS = product family name.

1 = chip number

G = Product type

C = Color ^[1]

0 = CRI (N/A=0 ; >70=7 ; >80=8 ; >90=9)

1000 = test current [mA]

1 = internal code

H = Brightness Level

AM = automotive application

Note :

^[1] Color :

Symbol	Description
C	Cool White
N	Neutral White
W	Warm White
PA	Phosphor Converted Amber
PR	Phosphor Converted Red
UB	Blue
IB	Ice Blue
SB	Sky Blue
UP	Purple
UG	Green
UY	Yellow
UYG	Brilliant Yellow Green
UPG	Pale Green
UA	Amber
UR	Red
SR	Super Red
RGB	RGB-Color

6. Ordering Information

ALFS1G-C010001H-**ABCDEFGHIJKLMN**-OP-AM

Part Number of the ALFS	Order Code
ALFS1G-C010001H-AM	ALFS1G-C010001H- ABCDEFGHIJKLMN -OP-AM

Order code contains information with below details :

ABCDEF= min/max wavelength or CCT

GHIJ= min./max. luminous flux in [lm] or luminous intensity in [mcd]

KLMN = min./max. Forward Voltage

OP = Packing quantity (Minimum package)

EVERLIGHT

7. Mechanical Dimension

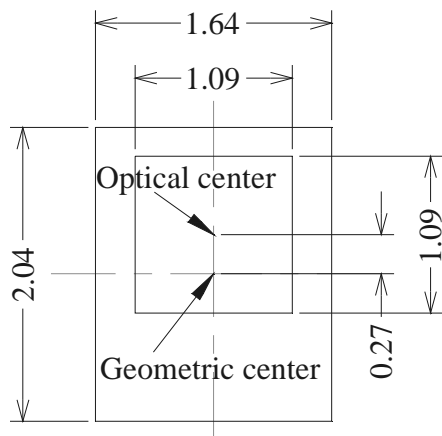

Top view

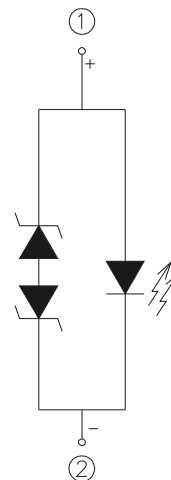

Polarity

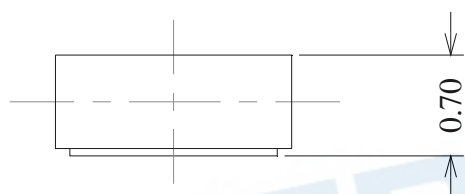

Side view

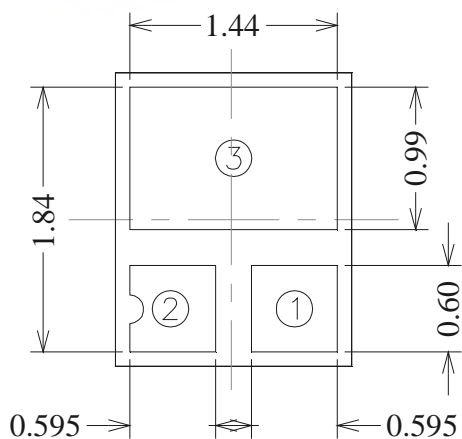

Bottom view

①	Anode
②	Cathode
③	Thermal pad

Notes:

1. Dimensions are in millimeters.
2. Tolerances unless mentioned are ± 0.1 mm.

Recommended Soldering Pad

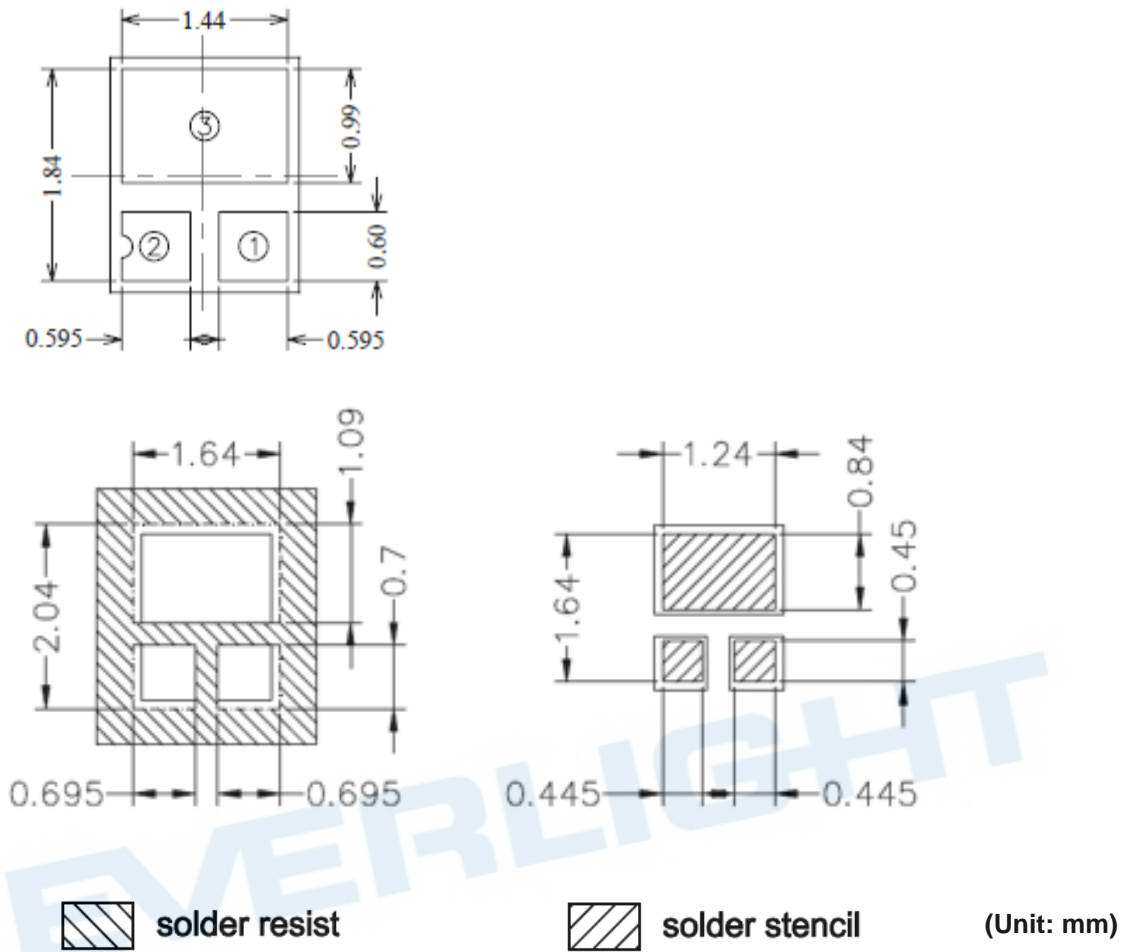

9. Reflow Soldering Profile

Soldering Condition (Reference: IPC/JEDEC J-STD-020D)

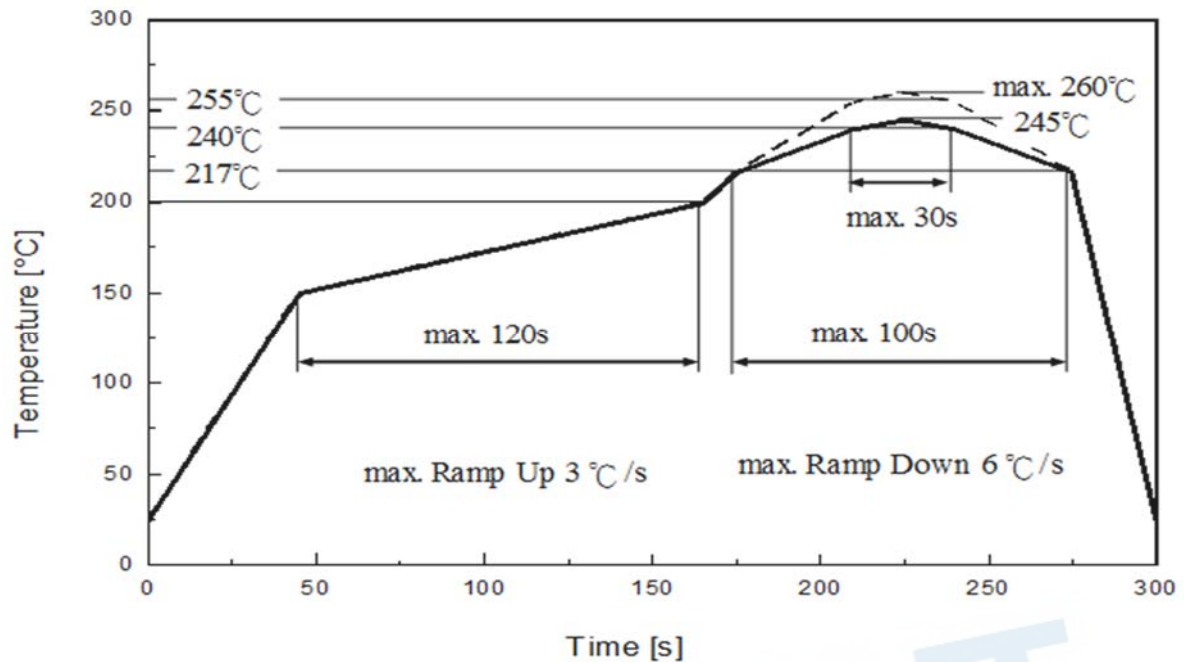

Profile Feature	Pb-Free Assembly	Unit Einheit
Ramp-up rate to preheat 25 °C to 150 °C	3	°C /sec
Time of soaking zone 150 °C to 200 °C	120	sec
Ramp-up rate to peak	3	°C /sec
Liquidus temperature	217	°C
Time above liquidus temperature	100	sec
Peak temperature (max.)	260	°C
Time within 5°C of the specified peak temperature	30	sec
Ramp-down Rate (max.)	6	°C /sec

10. Packaging Information

• Product Labeling

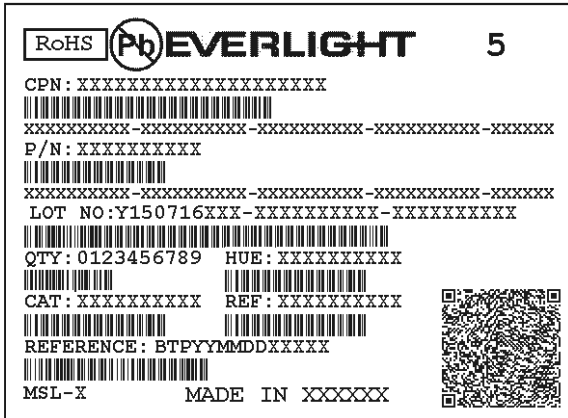

- CPN : Customer's Product Number
- P/N : Everlight Part Number
- LOT NO : Lot Number
- QTY : Packing Quantity
- HUE : Color Bin
- CAT : Luminous Flux (Brightness) Bin
- REF : Forward Voltage Bin

• Carrier Tape Dimensions as the following

Reel: 1000pcs, MOQ_≥ 100pcs (has to be a multiple of 100pcs)

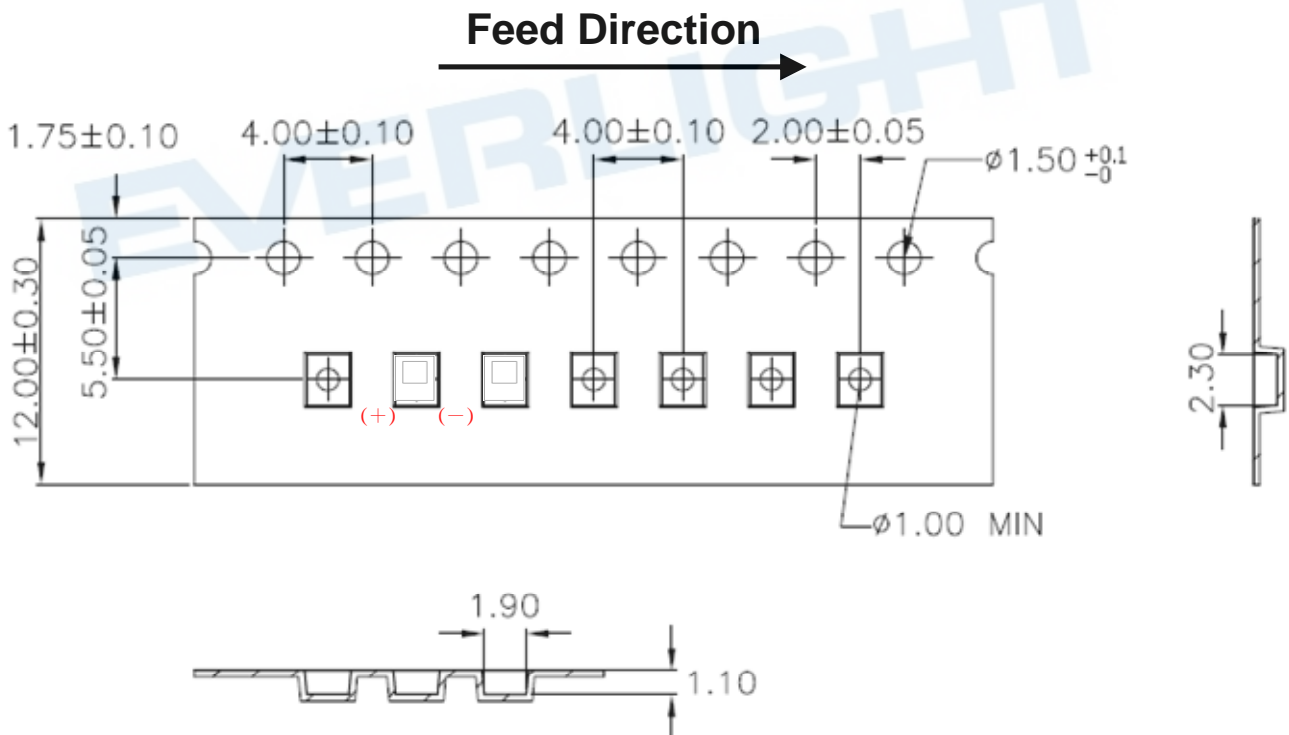

Notes:

1. Dimensions are in millimeters.

● **Reel Dimensions**

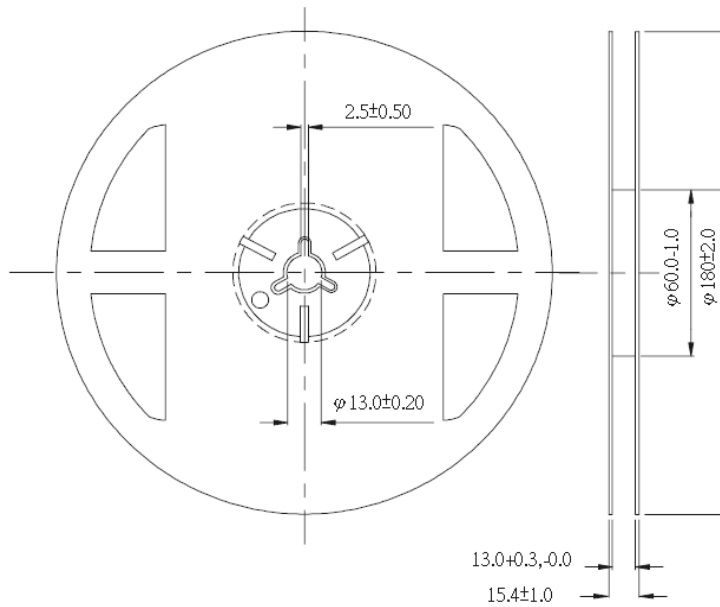

Notes:

1. Dimensions are in millimeters.

● **Moisture Resistant Packing Process**

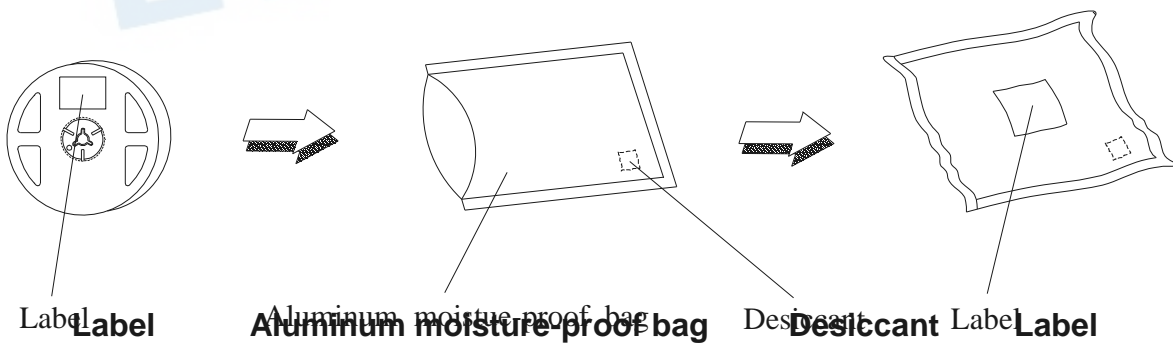

11. Precaution for Use

1. Over-current-proof

Customer must apply resistors for protection; otherwise slight voltage shift will cause big current change (burn out will happen).

2. Assemblies

Do not stack assemblies containing LEDs to prevent damage to the optical surface of LEDs. Forces applied to the optical surface may result in the surface being damaged.

3. Soldering Condition

3.1 When soldering, do not put stress on the LEDs during heating.

3.2 After soldering, do not warp the circuit board.

4. Soldering Iron

Each terminal is to go to the tip of soldering iron temperature less than 350°C for 3 seconds within once in less than the soldering iron capacity 25W. Leave two seconds and more intervals, and do soldering of each terminal. Be careful because the damage of the product is often started at the time of the hand solder.

5. Repairing

Repair should not be done after the LEDs have been soldered. When repairing is unavoidable, a double-head soldering iron should be used (as below figure). It should be confirmed beforehand whether the characteristics of the LEDs will or will not be damaged by repairing.

EVERLIGHT

Revision History

Current version: Aug.07.20

Issue No: DHE-0003753

Version: 1.0

Created by : Hsiang Yeh

Rev.	Subjects (major change in previous version)	Modified date
1	Standard data sheet	2020/08/07

EVERLIGHT